

TMC 3
N.T.S

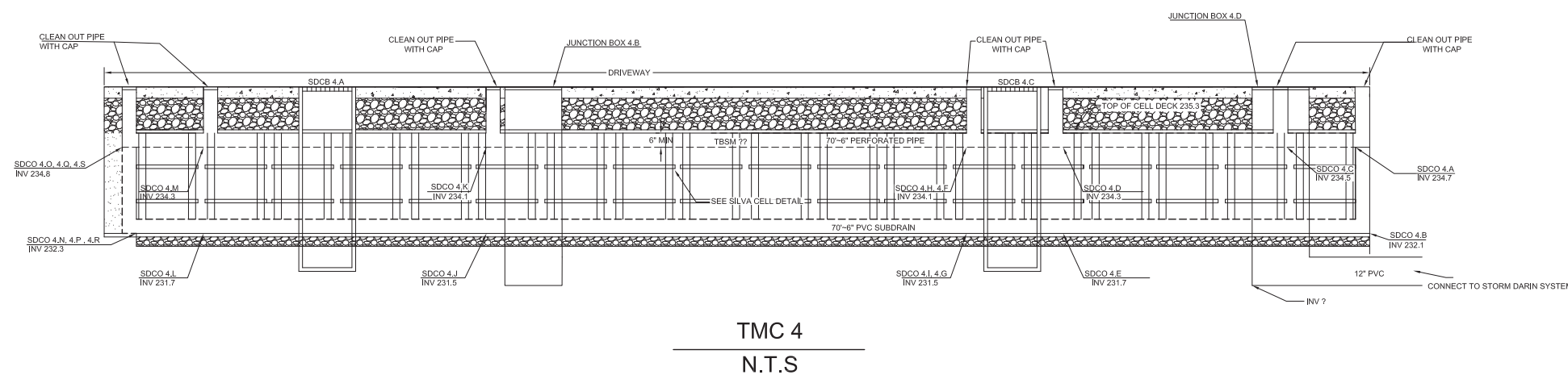

TMC 4
N.T.S

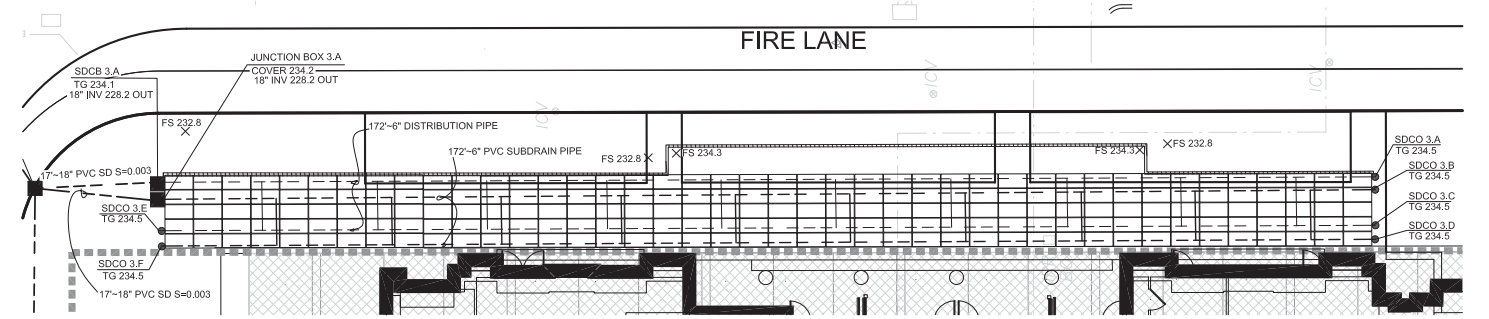
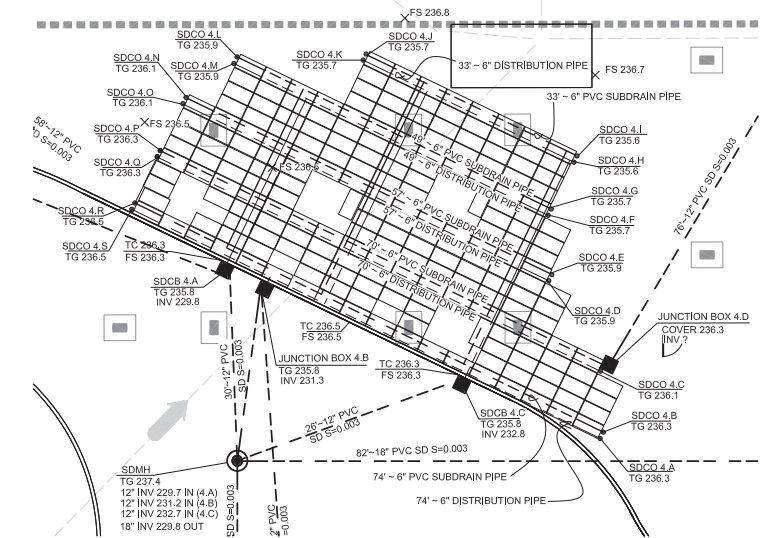

MARINA PLAZA

10145 DE ANZA BLVD. AND 10122 BANDLEY DR. CUPERTINO, CALIFORNIA
De Anza Venture, LLC

SILVA CELL DETAIL



JOB NO. 1250.001
DATE 04-21-16

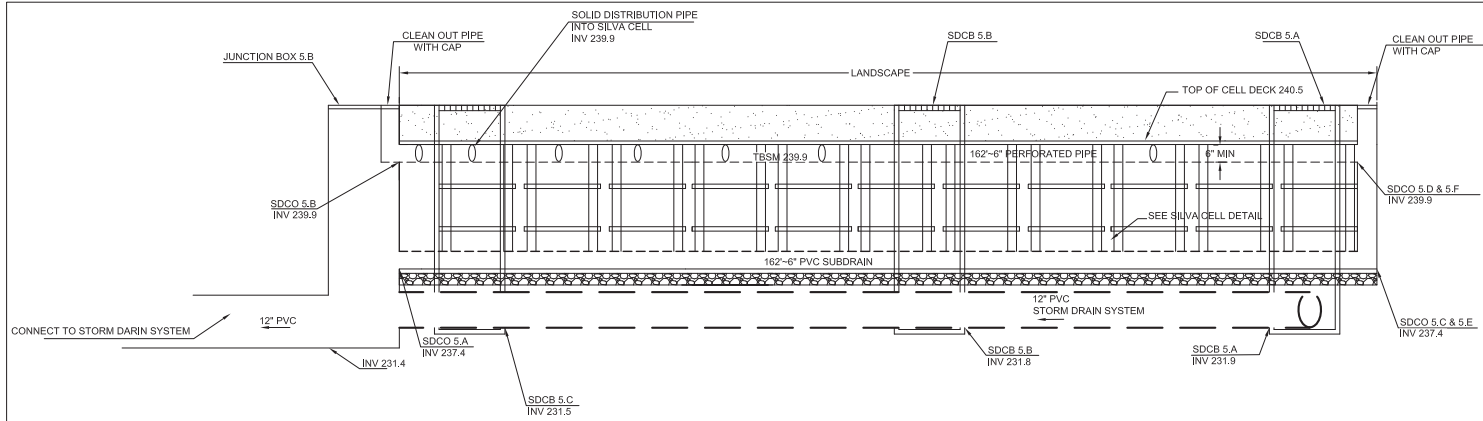

TMC 5
N.T.S

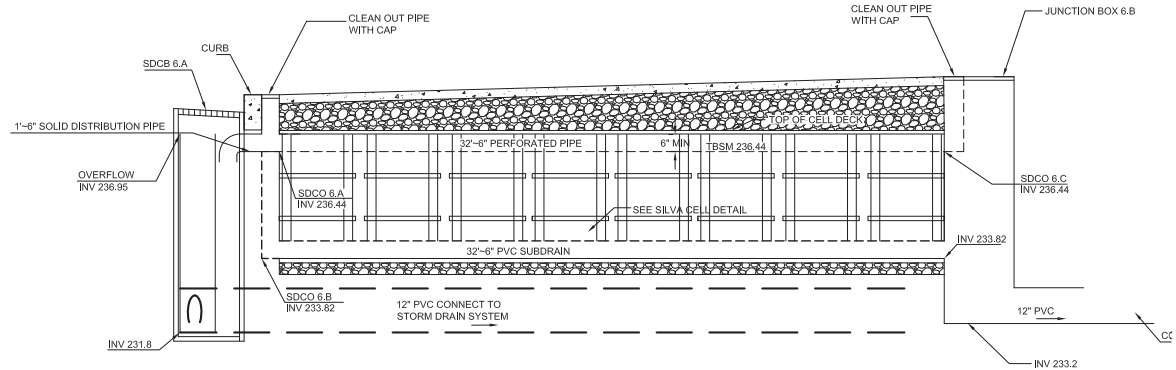
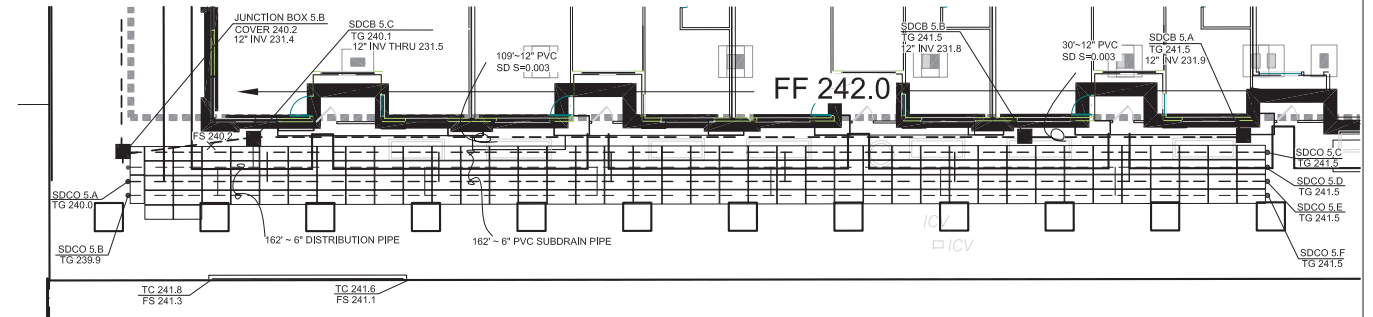

TMC 6
N.T.S

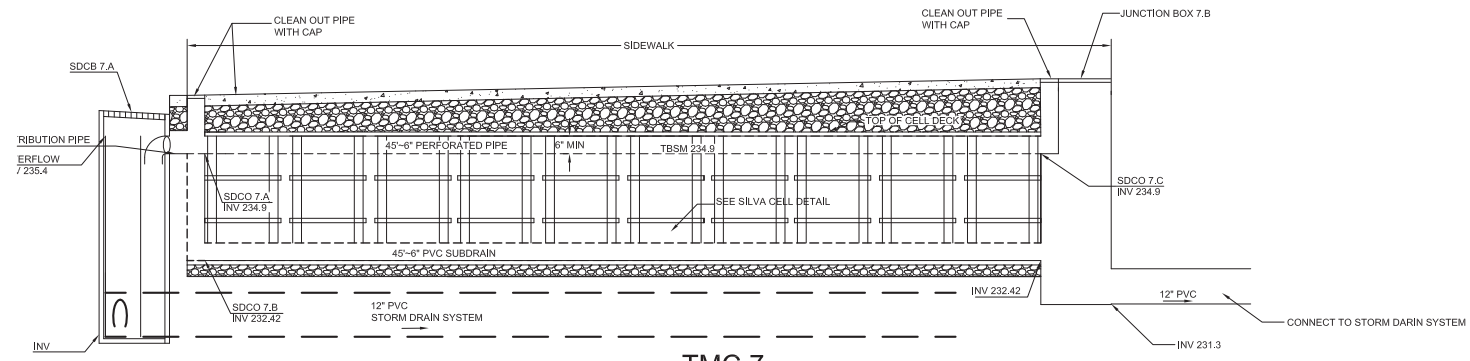
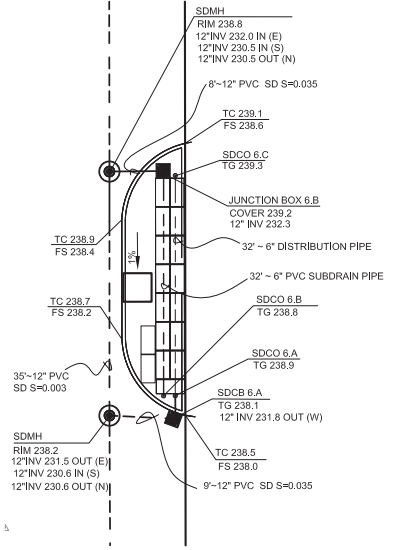

TMC 7
N.T.S

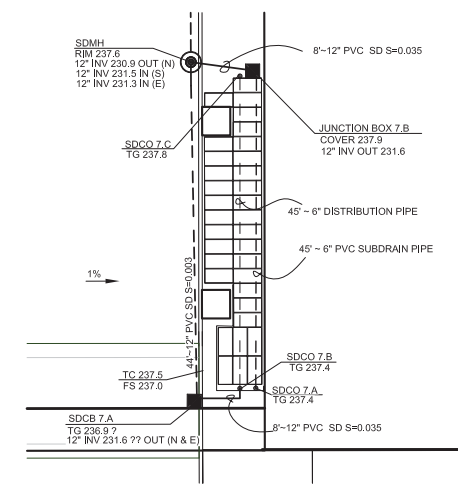

MARINA PLAZA

10145 DE ANZA BLVD. AND 10122 BANDLEY DR. CUPERTINO, CALIFORNIA
De Anza Venture, LLC

SILVA CELL DETAILS



JOB NO. 1250.001
DATE 04-21-16

NOTE:
 ① CONSTRUCT JUNCTION BOX OVER EXISTING 18" SD.
 INSTALL SOLID COVER . TG= 235.02±. INV=229.5±

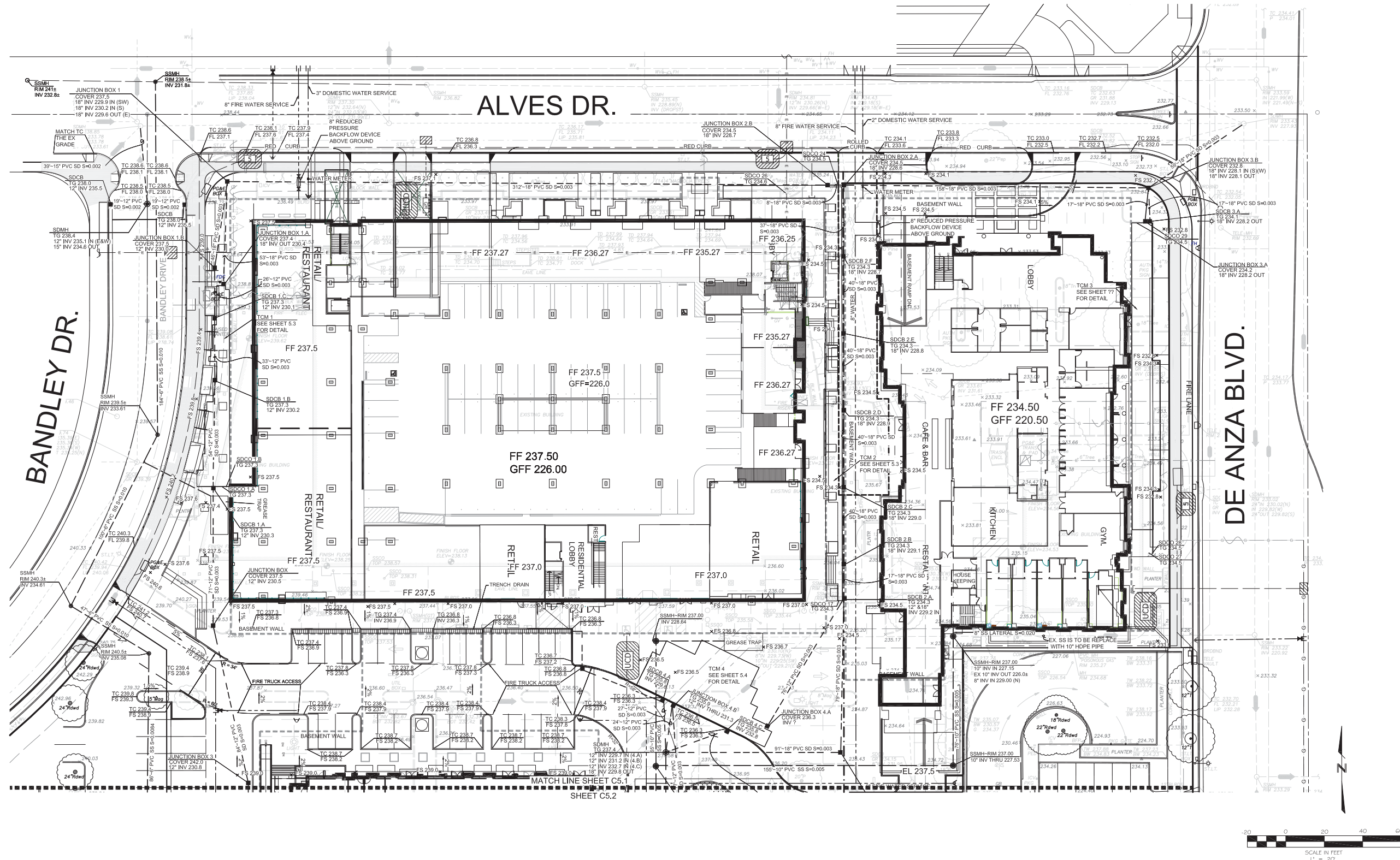

MARINA PLAZA

10145 DE ANZA BLVD. AND 10122 BANDLEY DR. CUPERTINO, CALIFORNIA
 De Anza Venture, LLC

UTILITY PLAN



JOB NO. 1250.001
 DATE 04-21-16

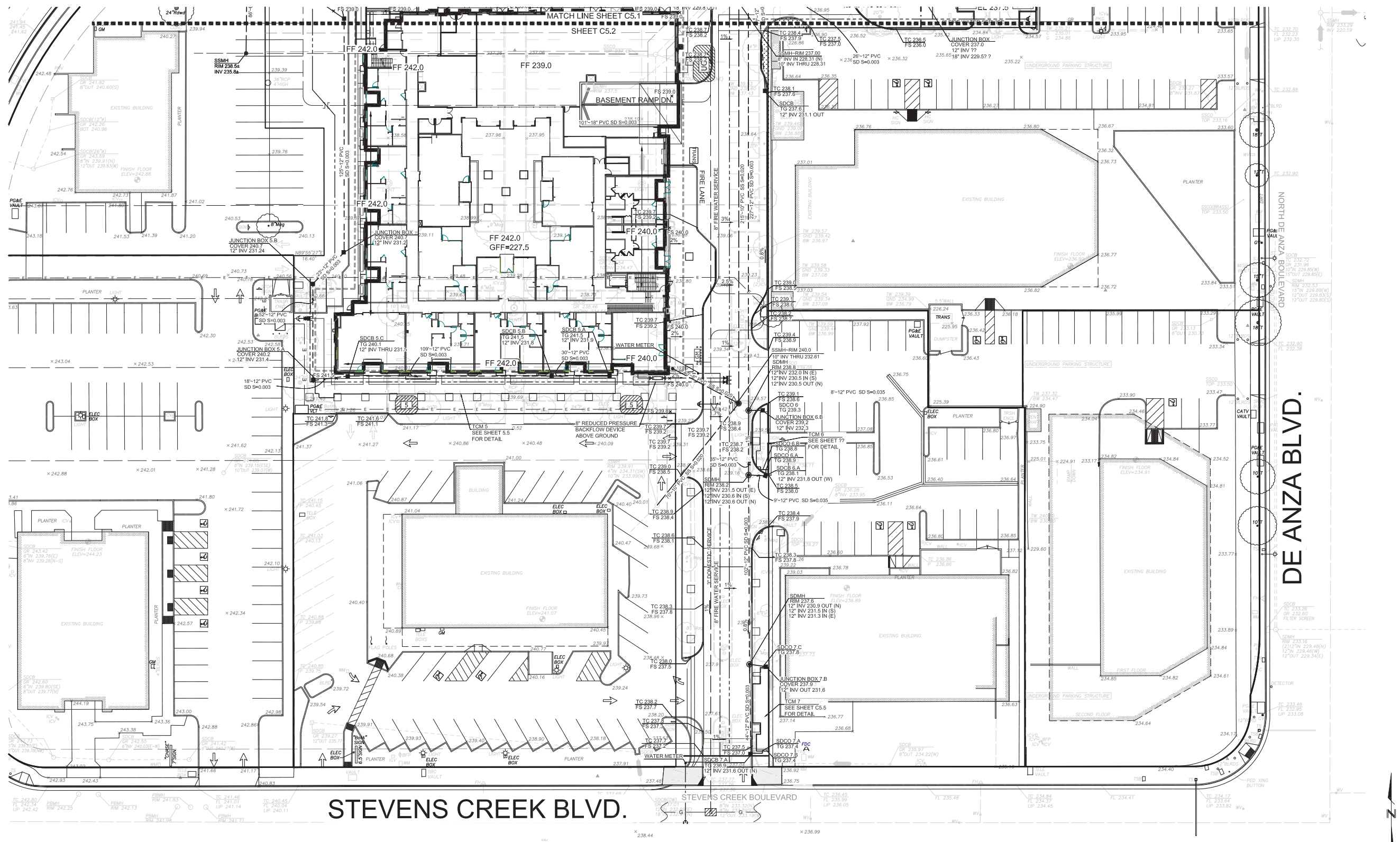

STEVENS CREEK BLVD.

STEVENS CREEK BOULEVARD

DE ANZA BLVD.

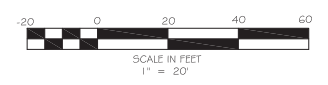

MARINA PLAZA

10145 DE ANZA BLVD. AND 10122 BANDLEY DR. CUPERTINO, CALIFORNIA
De Anza Venture, LLC

UTILITY PLAN



JOB NO. 1250.001
DATE 04-21-16

C5.2

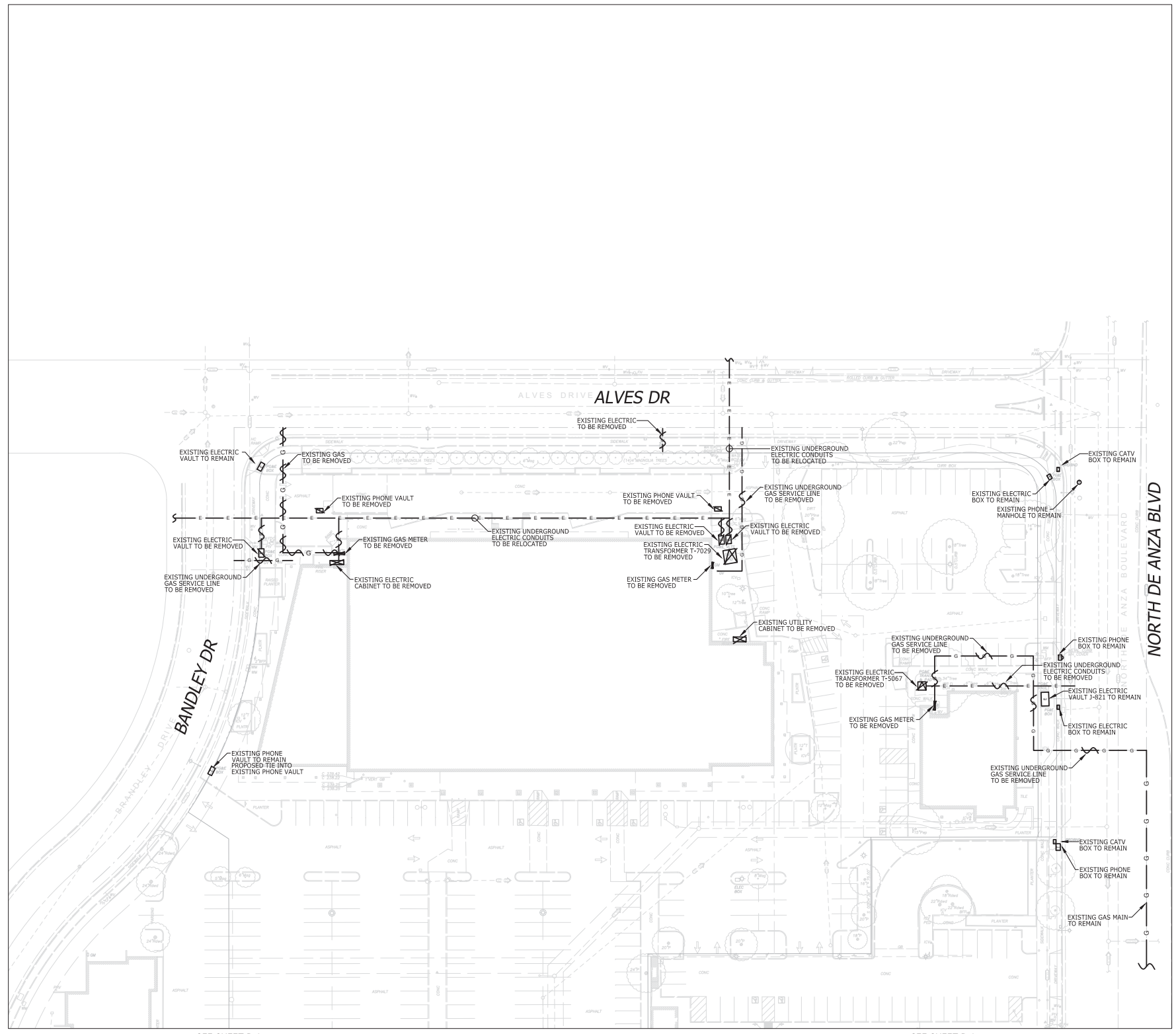

LEGEND:

	EXISTING ELECTRIC UNDERGROUND TO BE REMOVED
	EXISTING GAS SERVICE LINE TO BE REMOVED
	EXISTING ELECTRIC TRANSFORMER TO BE REMOVED
	EXISTING ELECTRIC VAULT TO BE REMOVED
	EXISTING PHONE VAULT TO BE REMOVED
	EXISTING GAS METER TO BE REMOVED
	EXISTING UTILITY CABINET TO BE REMOVED
	EXISTING ELECTRIC VAULT/BOX TO REMAIN
	EXISTING PHONE BOX TO REMAIN
	EXISTING CATV BOX TO REMAIN
	EXISTING UTILITY VAULT TO REMAIN

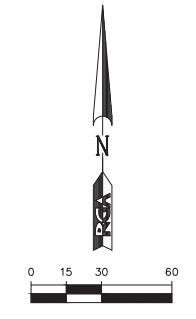

SHEET INDEX

R-1	REMOVAL PLAN
R-2	REMOVAL PLAN

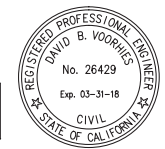

MARINA PLAZA

10145 DE ANZA BLVD. AND 10122 BANDLEY DR. CUPERTINO, CALIFORNIA
De Anza Venture, LLC

JOB NO. 1250.001
DATE 04-21-16



5865 Owens Drive
Pleasanton, CA 94588
925-251-7200

R-1

SEE SHEET R-1

SEE SHEET R-1

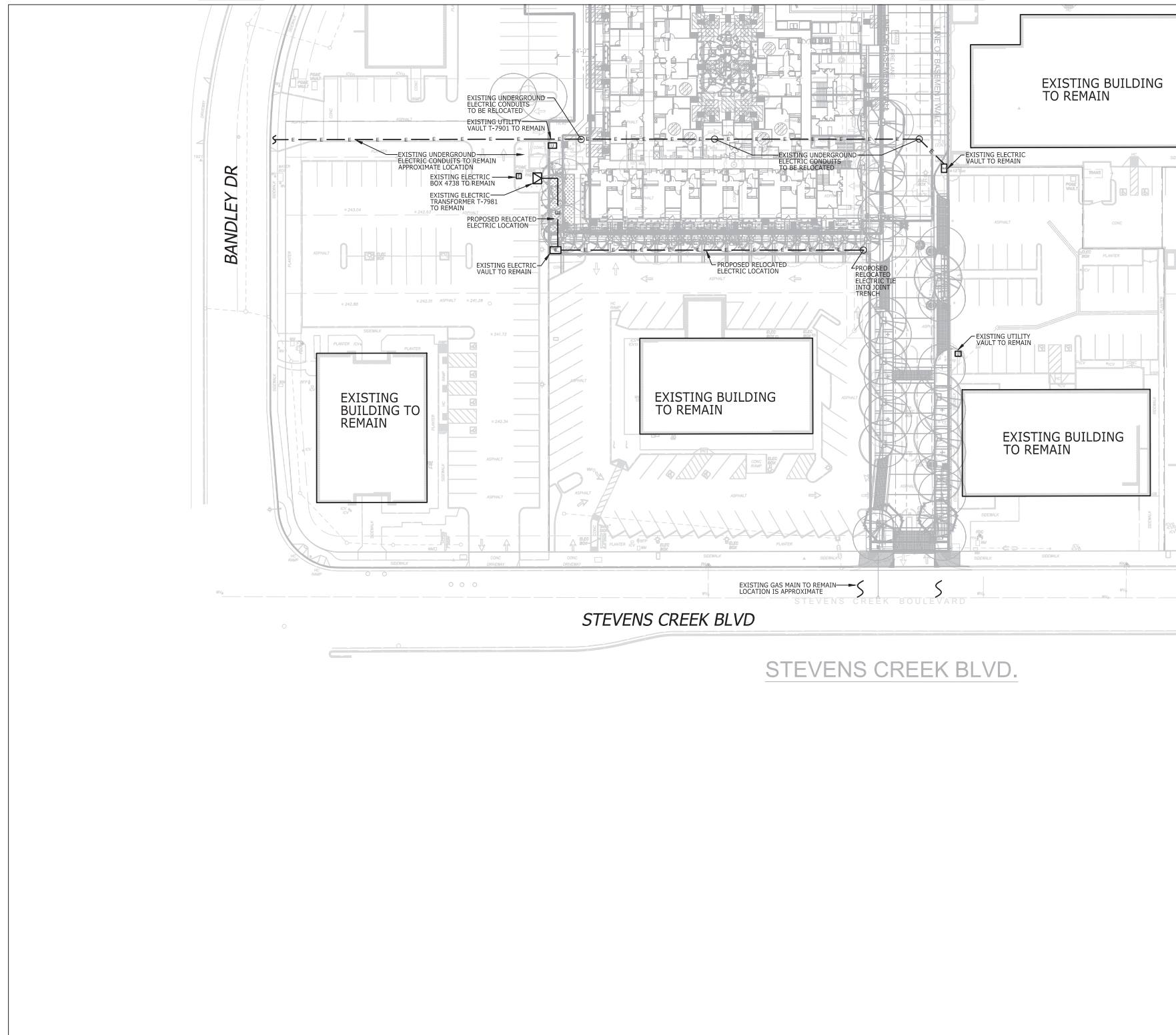

LEGEND:

- E — E — EXISTING ELECTRIC UNDERGROUND TO BE REMOVED
- G — G — EXISTING GAS SERVICE LINE TO BE REMOVED
- ⊠ EXISTING ELECTRIC TRANSFORMER TO BE REMOVED
- ⊠ EXISTING ELECTRIC VAULT TO BE REMOVED
- ⊠ EXISTING PHONE VAULT TO BE REMOVED
- ⊠ EXISTING GAS METER TO BE REMOVED
- ⊠ EXISTING UTILITY CABINET TO BE REMOVED
- ⊠ EXISTING ELECTRIC VAULT/BOX TO REMAIN
- ⊠ EXISTING PHONE BOX TO REMAIN
- ⊠ EXISTING CATV BOX TO REMAIN
- ⊠ EXISTING UTILITY VAULT TO REMAIN

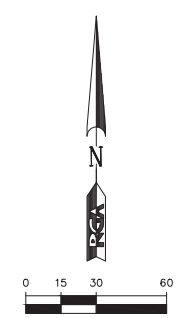

SHEET INDEX	
R-1	REMOVAL PLAN
R-2	REMOVAL PLAN

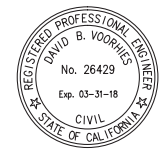

MARINA PLAZA

10145 DE ANZA BLVD. AND 10122 BANDLEY DR. CUPERTINO, CALIFORNIA
De Anza Venture, LLC

JOB NO. 1250.001
DATE 04-21-16



5865 Owens Drive
Pleasanton, CA 94588
925-251-7200

R-2

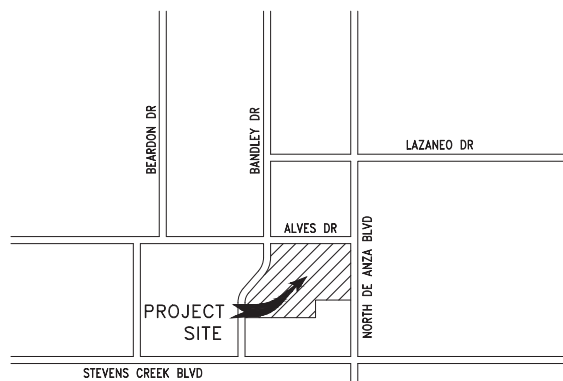

VICINITY MAP
N. T. S.

WORK RESPONSIBILITY
JOINT TRENCH

TRENCHING EXCAVATE & BACKFILL	PG&E ELECTRIC	PG&E GAS	PG&E TELEPHONE	C.A.T.V.	CONTRACTOR
GAS MATERIAL SUPPLY & INSTALL					
ELECTRIC CABLE SUPPLY & INSTALL					
ELECTRIC CONDUIT SUPPLY & INSTALL					
ELECTRIC BOXES SUPPLY & INSTALL					
ELECTRIC TRANSFORMER PADS SUPPLY & INSTALL					
ELECTRIC SWITCHGEAR & TRANSFORMER SUPPLY & INSTALL					
TELEPHONE CONDUIT SUPPLY & INSTALL					
TELEPHONE CABLE SUPPLY & INSTALL					
TELEPHONE SPLICE BOXES SUPPLY & INSTALL					
TELEPHONE S.A.I. PAD SUPPLY & INSTALL					
C.A.T.V. CONDUIT SUPPLY & INSTALL					
C.A.T.V. SPLICE BOXES SUPPLY & INSTALL					
DIRECTIONAL DRILL / JACK AND BORE SUPPLY & INSTALL					

● SYMBOL DESIGNATES THE WORK TO BE PERFORMED BY THE RESPECTIVE CONTRACTOR & UTILITY COMPANIES.
○ NOT APPLICABLE UNLESS OTHERWISE SPECIFIED
* PG&E TO PULL CABLE INTO ENERGIZED ENCLOSURES

THESE PLANS WERE PREPARED IN CONJUNCTION WITH THE FOLLOWING PLANS:

PLANS	RECEIVED	APPROVED
CIVIL IMPROVEMENT PLANS/GRADING PLANS	4-13-2016	PRELIMINARY
ARCHITECTURAL/ELECTRONIC FILE	4-14-2016	PRELIMINARY
APPLICANT DESIGN (GAS)		
APPLICANT DESIGN (ELECTRIC)		
TELEPHONE		
C.A.T.V.		
LANDSCAPE	4-18-2016	PRELIMINARY
LIGHT LOCATIONS		

RGA DESIGN is not responsible for any subsequent changes or revisions.

Other utilities shown are approximate and based on field survey and available utility information. It is the contractor's responsibility to verify the actual location and extent of utilities prior to the commencement of work. Physical verification of utility locations shall be performed by careful probing or hand digging in accordance with Article 6 of the CAL/OSHA construction safety orders.

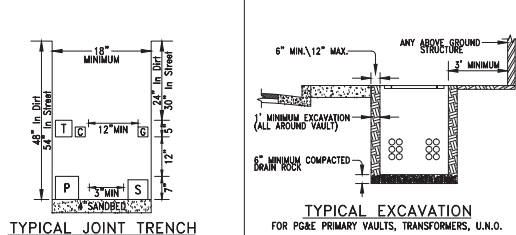

TYPICAL JOINT TRENCH

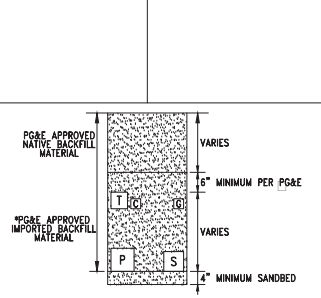

MINIMUM BACKFILL REQUIREMENTS
*CHECK WITH LOCAL GOVERNING AGENCIES FOR POSSIBLE VARIATIONS

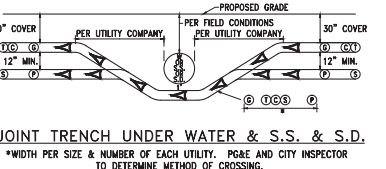

JOINT TRENCH UNDER WATER & S.S. & S.D.
*WIDTH PER SIZE & NUMBER OF EACH UTILITY. PG&E AND CITY INSPECTOR TO DETERMINE METHOD OF CROSSING.

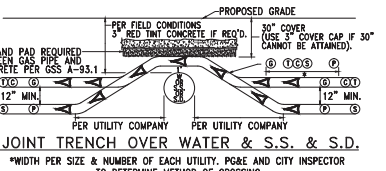

JOINT TRENCH OVER WATER & S.S. & S.D.
*WIDTH PER SIZE & NUMBER OF EACH UTILITY. PG&E AND CITY INSPECTOR TO DETERMINE METHOD OF CROSSING.

NOTE: MAXIMUM DEPTH ON PLASTIC PIPE TO BE 10'
TRENCHING CONTRACTOR SHALL NOT ASSUME THAT EITHER OF THE BELOW DETAILS WILL BE ACCEPTABLE TO PG&E WHO ARE REQUIRED TO CONTACT THE LOCAL PG&E ENGINEERING OFFICE WITH ANY ISSUE RELATING TO COVERS LESS THAN MINIMUM OR COVERS REQUIRING SHORING. CONCRETE CAPPING IS ONLY ACCEPTABLE WHERE NO OTHER SOLUTION IS POSSIBLE AND ONLY WHEN CERTAIN CRITERIA ARE MET AND ONLY WITH PG&E APPROVAL.

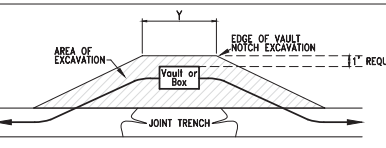

BOX EXCAVATION		NOTE:
PRIMARY BOX SIZE	7'	
3' x 5'	7'	DISTANCE VARIES PER FIELD CONDITIONS
4'-6" x 8'-6"	11'	

TYPICAL PG&E PRIMARY BOX EXCAVATION DETAIL

ELECTRIC CONDUIT MINIMUM BEND RADIUS		
CONDUIT DIAMETER	VERTICAL RADIUS	HORIZONTAL RADIUS
2"	24"	36"
3"	24"	36"
4"	36"	36"
5"	36"	60"

NOTE:
315' MAX BENDS IN ANY SECONDARY CONDUIT RUN 200' OR LESS.
300' MAX BENDS IN ANY PRIMARY CONDUIT RUN.

TYPICAL GAS METER REQUIREMENTS*						
METER TYPE	LOAD (SOFH)	DELIVERY PRESSURE** (PSIG)	PAD SIZE (INCHES)	MIN. WIDTH REQUIRED FOR METER 'X' (INCHES)	DISTANCE FROM RISER TO FINISHED WALL (INCHES)	MIN. HOUSELINE STUB OUT (INCHES)
TYPICAL RESIDENTIAL	0-350	0.25	N/A UNLESS USING FLEX-HOSE METER	24	6 TO 9	4
400 TO 1000 CLASS	351-1,400	0.25	N/A UNLESS USING FLEX-HOSE METER	30	6 TO 9	6
1.5M OR 3M ROTARY	1,401-3,000	APPROVED BY PG&E	40 X 36 X 4	52	20	VARIES
5M OR 7M ROTARY	3,001-7,000	APPROVED BY PG&E	78 X 36 X 4	90	20	VARIES
11M OR 15M ROTARY	7,001-16,000	APPROVED BY PG&E	94 X 36 X 4	106	20	VARIES

*ACTUAL METER-SET CONFIGURATIONS MAY DIFFER DEPENDING ON FIELD CONDITIONS AND RESTRICTIONS. FOR GAS METER DETAILS, SEE SECTION 2 OF CURRENT ELECTRIC AND GAS SERVICE REQUIREMENTS GREENBOOK BY PG&E.
**DELIVERY PRESSURE TO BE CONFIRMED VIA BUILDING PLUMBING AND MECHANICAL PLANS. PG&E MAINTAINS SOLE AUTHORITY TO DETERMINE IF THE ELEVATED DELIVERY-PRESSURE SERVICE IS AVAILABLE AT A SPECIFIC LOCATION.

×→
GM

GENERAL NOTES:

- THE PREFERRED TRENCH LOCATION IS IN A PUBLIC UTILITY EASEMENT (P.U.E.).
- ALL DEPTHS AND RESULTING COVER REQUIREMENTS ARE MEASURED FROM FINAL GRADE.
- COVER, CLEARANCES, AND SEPARATION SHALL BE AS GREAT AS PRACTICABLE UNDER THE CIRCUMSTANCES, BUT UNDER NO CIRCUMSTANCES SHALL BE LESS THAN THE MINIMUM COVER, CLEARANCE AND SEPARATION REQUIREMENTS SET FORTH IN GENERAL ORDER 128 AND 48CFR 192.321, 48CFR 192.325, AND 48CFR 192.327. ALL FACILITIES SHALL BE ANCHORED IN PLACE PRIOR TO COMPACTION, OR OTHER MEANS SHALL BE TAKEN TO ENSURE NO MOTION OF THE FACILITIES. DIMENSIONAL REQUIREMENTS FOR SHADING, LEVELING, AND BACKFILLING SHALL BE DETERMINED SUBSEQUENT TO COMPACTION.
- TRENCH DIMENSIONS SHOWN ARE TYPICAL. TRENCH SIZES AND CONFIGURATIONS MAY VARY DEPENDING UPON OCCUPANCY AND/OR FIELD CONDITIONS. TRENCH SIZE AND CONFIGURATION MUST AT ALL TIMES BE CONSTRUCTED IN A MANNER THAT ENSURES PROPER CLEARANCES AND COVER REQUIREMENTS ARE MET. ANY "CHANGE" TO THE TRENCH WIDTH AND CONFIGURATIONS AS SHOWN IN THIS EXHIBIT MUST BE DESIGNED TO ENSURE THIS REQUIREMENT.
- IT IS PREFERRED TO HAVE NON-PG&E OWNED STREETLIGHTS AT A LEVEL OTHER THAN THE GAS OR ELECTRIC LEVEL. NON-PG&E OWNED STREETLIGHTS MAY BE AT THE ELECTRIC LEVEL OF THE TRENCH AS LONG AS MINIMUM CLEARANCES ARE PROVIDED AND COMPLY WITH ALL SPECIAL NOTES FOR A JOINT TRENCH WITH A SECOND ELECTRIC UTILITY.
- NON-UTILITY FACILITIES ARE NOT ALLOWED IN ANY JOINT UTILITY TRENCH, E.G., IRRIGATION CONTROL LINES, BUILDING FIRE ALARM SYSTEMS, PRIVATE TELEPHONE SYSTEMS, OUTDOOR ELECTRICAL CABLE, ETC.
- WHEN COMMUNICATION DUCTS ARE INSTALLED, A MINIMUM OF 12" RADIAL SEPARATION SHALL BE MAINTAINED FROM GAS FACILITIES. EXCEPTION: WITH MUTUAL AGREEMENT, WHEN 4-INCH DIAMETER OR SMALLER GAS PIPE IS INSTALLED, THE SEPARATION MAY BE REDUCED TO NOT LESS THAN 6 INCHES.
- PROVIDE SEPARATION FROM TRENCH WALL AND OTHER FACILITIES SUFFICIENT TO ENSURE PROPER COMPACTION.
- MAINTAIN PROPER SEPARATION BETWEEN PG&E FACILITIES AND "WET" UTILITY LINES AS DESCRIBED IN UO STANDARD SS45. THE MINIMUM ALLOWABLE HORIZONTAL SEPARATION BETWEEN COMPANY FACILITIES AND "WET" FACILITIES IS 3' WITH A MINIMUM 1' OF UNDISTURBED EARTH OR THE INSTALLATION OF A SUITABLE BARRIER BETWEEN THE FACILITIES. IF A 3' HORIZONTAL SEPARATION CANNOT BE ATTAINED BETWEEN "WET" UTILITIES AND COMPANY DRY FACILITIES, A VARIANCE MAY BE APPROVED BY THE LOCAL INSPECTION SUPERVISOR AND SUBMITTED TO THE SERVICE PLANNING SUPPORT PROGRAM MANAGER FOR APPROVAL. SEPARATIONS OF 1' OR LESS ARE NOT PERMISSIBLE AND WILL NOT BE ALLOWED. THE COMPANY MAY AGREE TO WAIVE THE MINIMUM 3' SEPARATION REQUIREMENT AT THE REQUEST OF AN APPLICANT IF WARRANTED AND THE NEED IS JUSTIFIED. THE REQUEST FOR A WAIVER MUST:
- BE MADE IN WRITING AND SUBMITTED TO THE COMPANY ADE DURING THE PLANNING AND DESIGN PHASE OF THE PROJECT.
- CLEARLY DESCRIBE THE CONDITIONS NECESSITATING THE WAIVER.
- INCLUDE A PROPOSED DESIGN, AND INCLUDE A DESIGN FOR A BARRIER BETWEEN THE "WET" UTILITIES AND COMPANY DRY FACILITIES IN THE EVENT 1' OF UNDISTURBED EARTH CANNOT BE MAINTAINED. NOTE: DRAIN LINES CONNECTED TO DOWNSPOUTS ON BUILDINGS ARE CONSIDERED A "WET" UTILITY FOR THE PURPOSES OF THIS STANDARD.
- SEPARATIONS SHALL BE MAINTAINED AT ABOVEGROUND TERMINATION POINTS.
- PROCEDURES FOR APPROVING NATIVE BACKFILL FOR SHADING OF PG&E GAS FACILITIES:
 - RANDOM SOIL SAMPLES SHALL BE TAKEN FROM A MINIMUM OF 3 LOCATIONS PER 1,000' OF TRENCH. 100% OF THE SAMPLE MUST PASS THROUGH A 1/2" SIEVE AND 75% MUST PASS THROUGH A #4 SCREEN. ADDITIONAL SAMPLES MUST BE TAKEN IF EXISTING SOIL CONDITIONS CHANGE AND ARE TO BE TAKEN AT THE DISCRETION OF THE PG&E REPRESENTATIVE ON SITE.
 - THE SOILS MUST NOT CONTAIN ANY ROCKS THAT HAVE SHARP EDGES OR THAT MAY OTHERWISE BE ABRASIVE.
 - THE SOILS MUST NOT CONTAIN CLOUDS LARGER THAN 1/2" IF TO BE USED AS SHADING, BEDDING, OR LEVELING MATERIALS.
 - COMPACTION REQUIREMENTS MUST MEET ANY APPLICABLE PG&E, FEDERAL, STATE, COUNTY, OR LOCAL REQUIREMENTS.
 - AT NO TIME SHALL THE OVER SATURATION OF NATIVE SOILS BE USED TO ACHIEVE THESE REQUIREMENTS.
 - THE SIEVES AND SCREENS SHALL BE:
 - 1/2" SIEVE: 8" DIAMETER BY 2" DEEP, STAINLESS STEEL MESH SCREEN.
 - #4 SCREEN: 8" DIAMETER BY 2" DEEP, STAINLESS STEEL MESH SCREEN.
- PROCEDURES FOR APPROVING NATIVE BACKFILL FOR SHADING AT PG&E ELECTRIC FACILITIES:
 - RANDOM SOIL SAMPLES SHALL BE TAKEN FROM A MINIMUM OF 3 LOCATIONS PER 1,000' OF TRENCH. ADDITIONAL SAMPLES MUST BE TAKEN IF EXISTING SOIL CONDITIONS CHANGE AND ARE TO BE TAKEN AT THE DISCRETION OF THE PG&E REPRESENTATIVE ON SITE.
 - SHADING MATERIAL CONTAINING LARGE ROCK, PAYING MATERIAL, CONDEMS, SHARPLY ANGULAR SUBSTANCES, OR CORROSIVE MATERIAL SHALL NOT BE PLACED IN THE TRENCH WHERE SUCH MATERIAL MAY DAMAGE THE CONDUITS AND/OR PREVENT PROPER COMPACTION OVER OR AROUND THE CONDUITS.
 - NATIVE SOILS CONTAINING CLOUDS NOT TO EXCEED 6" IN DIAMETER MAY BE INCLUDED IN THE SHADING MATERIAL PROVIDED THE CLOUDS ARE EASILY BREAKABLE BY HAND. NOTE: SOILS CONSISTING PRIMARILY OF ADOBE, HARD COMPACT (DENSE) CLAY, AND BAY MUDS SHALL NOT BE USED AS SHADING MATERIAL.
 - AT NO TIME SHALL THE OVER SATURATION OF NATIVE SOILS BE USED TO ACHIEVE THESE REQUIREMENTS.
 - REFER TO ENGINEERING DOCUMENT 062288, ITEM 13 ON PAGE 2.
- COMPETENT NATIVE SOILS ARE PREFERRED TO BE USED FOR SHADING, BEDDING, AND BACKFILLING THROUGHOUT THE TRENCH.
- WHERE NATIVE SOILS EXCEED 1/2" MINUS AND/OR WHERE GAS IS TO BE PLACED AT THE BOTTOM OF A TRENCH IN AREAS THAT EXCEED 1/2" MINUS SOIL CONDITIONS, OR WHERE THE BOTTOM OF A TRENCH IS CONSIDERED TO CONSIST OF HARD PAN, PG&E APPROVED 1/2" MINUS IMPORT MATERIAL SHALL BE USED FOR SHADING AND/OR BEDDING OF GAS FACILITIES.
- PG&E APPROVED IMPORT MATERIAL IS PER DOT ENGINEERING GUIDELINE 4123.
- IF A LEVELING COURSE IS REQUIRED FOR GAS FACILITIES, THE USE OF NATIVE SOILS IS PREFERRED, BUT IF 1/2" MINUS CONDITIONS ARE NOT ATTAINABLE WITH THE NATIVE SOILS, THEN THE USE OF PG&E APPROVED IMPORT MATERIAL IS REQUIRED. BEDDING UNDER GAS FACILITIES WILL BE A MINIMUM OF 2" OF COMPACTED 1/2" MINUS NATIVE SOILS OR PG&E APPROVED IMPORT MATERIAL.
- FOR ELECTRIC FACILITIES, REFER TO NOTE 12. THIS APPLIES TO LEVELING COURSES AS WELL AS SHADING.
- THE MINIMUM PG&E APPROVED BEDDING MATERIAL SHALL BE A MINIMUM OF 2" OF COMPACTED 1/2" MINUS NATIVE SOILS OR PG&E APPROVED IMPORT MATERIAL.
- THE USE OF ANY IMPORTED MATERIAL FOR BACKFILLING PURPOSES SHALL BE LIMITED TO THOSE SITUATIONS WHEN NATIVE SOILS DO NOT ALLOW FOR REQUIRED COMPACTION.
- THE APPLICANT IS RESPONSIBLE FOR THE REMOVAL OF EXCESS SPOIL AND ASSOCIATED COSTS.
- SEPARATION BETWEEN GAS FACILITIES AND ELECTRIC FACILITIES MAY BE REDUCED TO 6" WHEN CROSSING.
- SERVICE SADDLES ARE THE PREFERRED SERVICE FITTINGS FOR USE THROUGHOUT THE JOINT TRENCH PROJECT. ALL PROJECTS WILL BE DESIGNED AND ESTIMATED USING SERVICE SADDLES. HOWEVER, SERVICE TEES MAY BE USED IF ALL CLEARANCES, SEPARATION, AND COVER REQUIREMENTS ARE MAINTAINED.

TRANSFORMER CLEARANCE REQUIREMENTS:

- ABOVE ANY SINGLE PHASE TRANSFORMER LOCATION, MAINTAIN 20' UNOBSTRUCTED OVERHEAD CLEARANCE OVER TRANSFORMER VAULT/PAD.
- ABOVE ANY THREE PHASE TRANSFORMER LOCATION, MAINTAIN 30' UNOBSTRUCTED OVERHEAD CLEARANCE OVER TRANSFORMER VAULT/PAD.

GAS PIPELINE UNDERGROUND WARNING TAPE NOTES:

- A WARNING TAPE IS TO BE INSTALLED IN OPEN TRENCH INSTALLATION OVER GAS PIPELINES IN BOTH TRANSMISSION AND DISTRIBUTION FACILITIES. THIS INCLUDES TRENCHES, BELL HOLES, EXCAVATIONS FOR REPAIR PURPOSES AND RISER REPLACEMENTS. THE WARNING TAPE IS INTENDED FOR EXCAVATOR DIGGING IN THE "TOLERANCE ZONE" TO STRIKE THE WARNING TAPE PRIOR THAN THE PIPELINE. WHEN THE WARNING TAPE IS EXPOSED AND GRABBED WITH EXCAVATING EQUIPMENT, IT STRETCHES WITHOUT BREAKING, THUS ALERTING THE EXCAVATOR OF THE GAS FACILITY BELOW.
- INSTALL 6" WIDE WARNING TAPE ABOVE THE GAS PIPELINE AT LEAST 12" BELOW GRADE, AND NO CLOSER THAN 12" FROM THE PIPE. INSTALLATION SHOULD PROVIDE THE GREATEST DISTANCE BETWEEN THE PIPELINE AND THE TAPE AS POSSIBLE. INSTALL THE TAPE ALONG THE LENGTH OF THE EXCAVATION, ENSURING THAT THE TAPE OVERLAPS WHEN TWO OR MORE PIECES OF TAPE ARE USED. EXCEPTION: WHEN A JOINT TRENCH DESIGN DOES NOT ALLOW FOR INSTALLMENT OF WARNING TAPE WITHIN THE "WARNING TAPE INSTALLATION ZONE", INSTALL THE WARNING TAPE A MINIMUM OF 8" ABOVE THE GAS PIPELINE, AND BELOW THE FACILITY ABOVE THE PIPE.
- WARNING TAPE SHALL BE BRIGHTLY COLORED YELLOW AND MARKED "CAUTION: GAS LINE BURIED BELOW" OR MARKED WITH A SIMILAR NOTIFICATION.
- WARNING TAPE SHALL BE STORED IN SUCH A MANNER THAT LIMITS ULTRAVIOLET (UV) EXPOSURE.

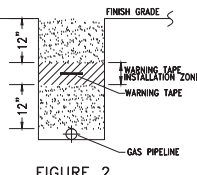

FIGURE 2
GAS PIPELINE UNDERGROUND WARNING TAPE INSTALLATION

PG&E PM#S:
ELECTRIC:
GAS:

DESIGN CHANGE COMPONENT
ANY CHANGES TO THIS DESIGN
MUST BE APPROVED BY

PG&E GAS ADE

CONSTRUCTION NOTES:

- ALL TRENCHING, BACKFILLING AND INSTALLATION BY CONTRACTOR MUST COMPLY WITH PG&E UO STANDARD SS453 (EFFECTIVE DATE 7-5-2006).
- ALL WORK MUST COMPLY WITH P.G. & E. TELEPHONE, C.A.T.V., STANDARDS AND PRACTICES. ALL WORK MUST BE INSPECTED AND APPROVED BY RESPECTIVE INSPECTORS. RANDOM SOIL SAMPLES SHALL BE TAKEN FROM A MINIMUM OF THREE LOCATIONS PER 1,000' OF TRENCH. 100% OF THE SAMPLE MUST PASS THROUGH A 1/2" SIEVE AND 75% MUST PASS THROUGH A #4 SCREEN. ADDITIONAL SAMPLES MUST BE TAKEN IF EXISTING SOIL CONDITIONS CHANGE AND IS TO BE AT THE DISCRETION OF THE PG&E REPRESENTATIVE ON SITE. THE SOILS MUST NOT CONTAIN ANY ROCKS THAT HAVE SHARP EDGES OR THAT MAY OTHERWISE BE ABRASIVE. THE SOILS MUST NOT CONTAIN CLOUDS LARGER THAN 1/2" IF TO BE USED AS SHADING, BEDDING OR LEVELING MATERIALS. COMPACTION REQUIREMENTS MUST MEET ANY APPLICABLE P.G. & E. FEDERAL, STATE, COUNTY OR LOCAL REQUIREMENTS. ANY NATIVE SOILS OR IMPORT MATERIALS USED MUST NOT HINDER THOSE EFFORTS.
- BACKFILL SHALL BE APPROVED BY THE UTILITY COMPANIES AND THE CITY. COMPACTION WILL BE TESTED AND PASSED BY THE SOILS ENGINEER.
- IF SOIL IS NOT ROCK FREE, ADD 4" DEPTH OF TRENCH FOR SAND BEDDING.
- VERIFY SPLICE BOX EXCAVATION SIZES WITH SUPPLIER(S).
- THE TRENCHING CONTRACTOR SHALL COORDINATE THE UTILITY COMPANIES' INSTALLATION.
- CONTRACTOR SHALL MAKE HIMSELF FAMILIAR WITH THE PROJECT IMPROVEMENT PLANS AND CONDUCT HIS WORK ACCORDINGLY.
- IT IS THE TRENCHING CONTRACTOR'S RESPONSIBILITY TO PROTECT IN PLACE ALL EXISTING FACILITIES. NO EXTRA PAYMENT WILL BE CONSIDERED FOR CROSSING OTHER SYSTEMS.
- RG&A DESIGN ASSUMES NO RESPONSIBILITY FOR THE PROJECT CONDITIONS. THESE DRAWINGS WERE PREPARED USING DATA SUPPLIED BY PG&E, TELEPHONE, C.A.T.V., IMPROVEMENT PLANS AND THE CITY'S VARIOUS "AS BUILT" INFORMATION. IT SHALL BE THE CONTRACTOR'S RESPONSIBILITY TO PHYSICALLY REVIEW THE PROJECT PRIOR TO SUBMITTING HIS BID.
- CONTRACTOR WILL COMPLY WITH ALL LAWS, ORDINANCES AND REGULATIONS. CONTRACTOR SHALL BE FAMILIAR WITH O.S.H.A., INDUSTRIAL SAFETY ORDERS AND SHALL CONDUCT HIS WORK ACCORDINGLY. WHEN WORKING NEAR ENERGIZED OR "HOT" EQUIPMENT, THE UTILITY OWNER SHALL BE NOTIFIED TO SUPPLY THE APPROPRIATE MAN POWER. PUBLIC SAFETY AND TRAFFIC CONTROL MEASURES ARE THE CONTRACTOR'S RESPONSIBILITY.
- THE CONTRACTOR SHALL PROTECT CONSTRUCTION STAKING. HE SHALL COORDINATE STAKING WITH THE PROJECT'S CIVIL ENGINEER.
- CONTRACTOR SHALL NOTIFY UNDERGROUND SERVICE ALERT (USA) TWO WORKING DAYS PRIOR TO START OF WORK.
- CONTRACTOR SHALL NOTIFY INSPECTORS OF ANY POTENTIAL CONFLICTS PRIOR TO START OF WORK.
- THIS PLAN IS TO BE USED FOR SOLE PURPOSE OF DIGGING THE JOINT TRENCH. SEE PG&E, AT&T, AND COMCAST PLANS FOR EXACT SIZE AND NUMBER OF CONDUITS INSTALLED IN THE JOINT TRENCH. IT IS THE CONTRACTOR'S RESPONSIBILITY TO ENSURE THE CORRECT NUMBER, SIZE AND TYPES OF CONDUITS ARE INSTALLED PER THE ENGINEERED PLANS BY EACH UTILITY COMPANY.
- NOTE PLANS ISSUED AT THE PRE-CONSTRUCTION MEETING MAY BE SUBJECT TO REVISIONS, IF FINAL PLANS FROM EACH UTILITY COMPANY WERE NOT AVAILABLE AT THE START OF CONSTRUCTION.
- WATER, SEWER, DRAINS, SANITARY WASTE, FUELS (INCLUDING DIESEL AND GASOLINE), OIL, PROPANE, AND OTHER VOLATILE HEAVIER THAN AIR GASES, SPRINKLER, IRRIGATION, STEAM AND OTHER "WET" FACILITIES SHALL MAINTAIN A MINIMUM OF THREE FEET FROM THE NEAREST OUTER SURFACE OF PG&E FACILITIES WITH NO LESS THAN ONE FOOT OF EARTH (SOIL BARRIER) BETWEEN THE ADJACENT SIDES OF THE INDIVIDUAL TRENCHES.
- IN THE EXTRAORDINARY CASE THAT THE MINIMUM THREE FOOT HORIZONTAL SEPARATION CANNOT BE ATTAINED BETWEEN "WET" UTILITIES AND COMPANY DRY FACILITIES, A VARIANCE MAY BE APPROVED BY THE LOCAL INSPECTION SUPERVISOR AND SUBMITTED TO SERVICE PLANNING SUPPORT PROGRAM MANAGER FOR APPROVAL.
- ALL METER PANELS: INDIVIDUAL, RESIDENTIAL, OR NONRESIDENTIAL APPLICANTS WITH A METER PANEL RATING OF ANY SIZE, INSTALLED INSIDE A METER ROOM OR OTHER STRUCTURE, MUST FOLLOW ALL OF THE REQUIREMENTS DESCRIBED BELOW.
 - A. INSTALL, OWN, AND MAINTAIN A SEPARATE, NOMINAL, 2-INCH DIAMETER CONDUIT WITH PULL TAPE INSIDE. THE CONDUIT AND PULL TAPE MUST EXTEND FROM THE OUTSIDE SURFACE OF THE BUILDING AND TERMINATE OUTSIDE THE METER PANEL OR SWITCHBOARD AT THE TOP OF THE METER SECTION.
 - B. ENSURE THE 2-INCH DIAMETER CONDUIT AND PULL TAPE EXIT THE OUTSIDE OF THE BUILDING A MINIMUM OF 8 FEET AND A MAXIMUM OF 10 FEET ABOVE GROUND. THE OPEN END OF THE CONDUIT THAT IS EXPOSED TO THE OUTSIDE MUST HAVE A REMOVABLE, TEMPORARY CAP OR PLUG.
 - C. DO NOT USE THE CONDUIT. THE CONDUIT IS FOR PG&E'S METERING EQUIPMENT ONLY.

SUBSTRUCTURE VERIFICATION STAMP

DEVELOPER
PLEASE NOTE AND SIGN

ALL PG&E ENCLOSURES AND BOXES HAVE BEEN SET TO GRADE ACCORDING TO GRADE STAKES PROVIDED BY DEVELOPER'S ENGINEER. ALL COSTS TO RELOCATE OR RE-ADJUST BOXES AT A LATER DATE WILL BE BILLED TO THE DEVELOPER. PLEASE HAVE YOUR SPT. VERIFY THE CORRECT GRADE OF ALL ENCLOSURES OR BOXES, AND SIGN AND DATE DRAWING.

SIGNED: _____ THANK YOU
DATE _____

UTILITY APPROVALS		
UTILITY	APPROVED BY	DATE
PG&E ELECTRIC		
PG&E GAS		
AT&T (PHONE)		
COMCAST (CATV)		
CITY ENGINEER		

FOR RGA USE ONLY QA REVIEW		
PHASE	INITIALS	DATE
INTENT		
COMPOSITE		
PRE-CON		

SHEET INDEX
JT-1 JOINT TRENCH TITLE SHEET
JT-2,3 JOINT TRENCH INTENT

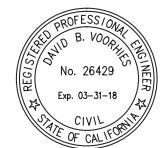

DEVELOPER:
MARINA FOODS / DEANZA VENTURES
10122 BANDLEY DR
CUPERTINO, CA 95014
CHRISTOPHER HUANG
650-492-0120

MARINA PLAZA

10145 DE ANZA BLVD. AND 10122 BANDLEY DR. CUPERTINO, CALIFORNIA
De Anza Venture, LLC

JOB NO. 1250.001
DATE 04-21-16



5865 Owens Drive
Pleasanton, CA 94588
925-251-7200

SUBSTRUCTURE LOCATIONS MUST BE STAKED BY A LICENSED SURVEYOR PRIOR TO CONSTRUCTION

NOTE TO COMCAST:
PLEASE CONFIRM WHO WILL PROVIDE CONDUIT AND VAULTS. DEVELOPER TO PROVIDE TRENCH.

NOTE FOR UNDERGROUND ELECTRIC INSTALLATION:
USE OF STANDARD PVC DB-120 IS NO LONGER APPROVED BY PG&E FOR 2" CONDUIT SIZE AND BENDS. PVC DB-120 CELLULAR CORE CONDUIT CAN BE USED IN PLACE OF STANDARD PVC DB-120 CONDUIT. FOR ALL APPROVED 2" CONDUITS AND BENDS, SEE BULLETIN TD-062288B-001.

UTILITIES
PLEASE CONFIRM TIE IN LOCATIONS **-PRELIMINARY-**
NOT FOR CONSTRUCTION

SEE BUILDING PLANS FOR CONDUIT ENTRY INTO BUILDING. DEVELOPER'S RESPONSIBILITY TO BUILD ELECTRIC METER ROOM IN COMPLIANCE WITH CURRENT PG&E GREEN BOOK SECTION 10 STANDARD. DO NOT BOTTOM FEED ELECTRIC CONDUITS INTO PANEL WHEN PANEL IS BELOW GRADE.

REFER TO PG&E UTILITY BULLETIN TD-70018-005 DOCUMENT FOR SMART METER ANTENNA CONSTRUCTION REQUIREMENTS.

SEE CURRENT AT&T/CATV SPECIFICATIONS FOR ROOM AND BACKBOARD REQUIREMENTS.

SEE BUILDING PLANS FOR GAS PIPE ENTRY INTO BUILDING. DEVELOPER'S RESPONSIBILITY TO BUILD GAS METER ROOM IN COMPLIANCE WITH CURRENT PG&E GREEN BOOK 1.16 STANDARD.

ELECTRIC & GAS EQUIPMENT NOTE: ALL ELECTRIC EQUIPMENT ARE PROPOSED UNDERGROUND AND ALL GAS EQUIPMENT ARE PROPOSED ABOVE GROUND.

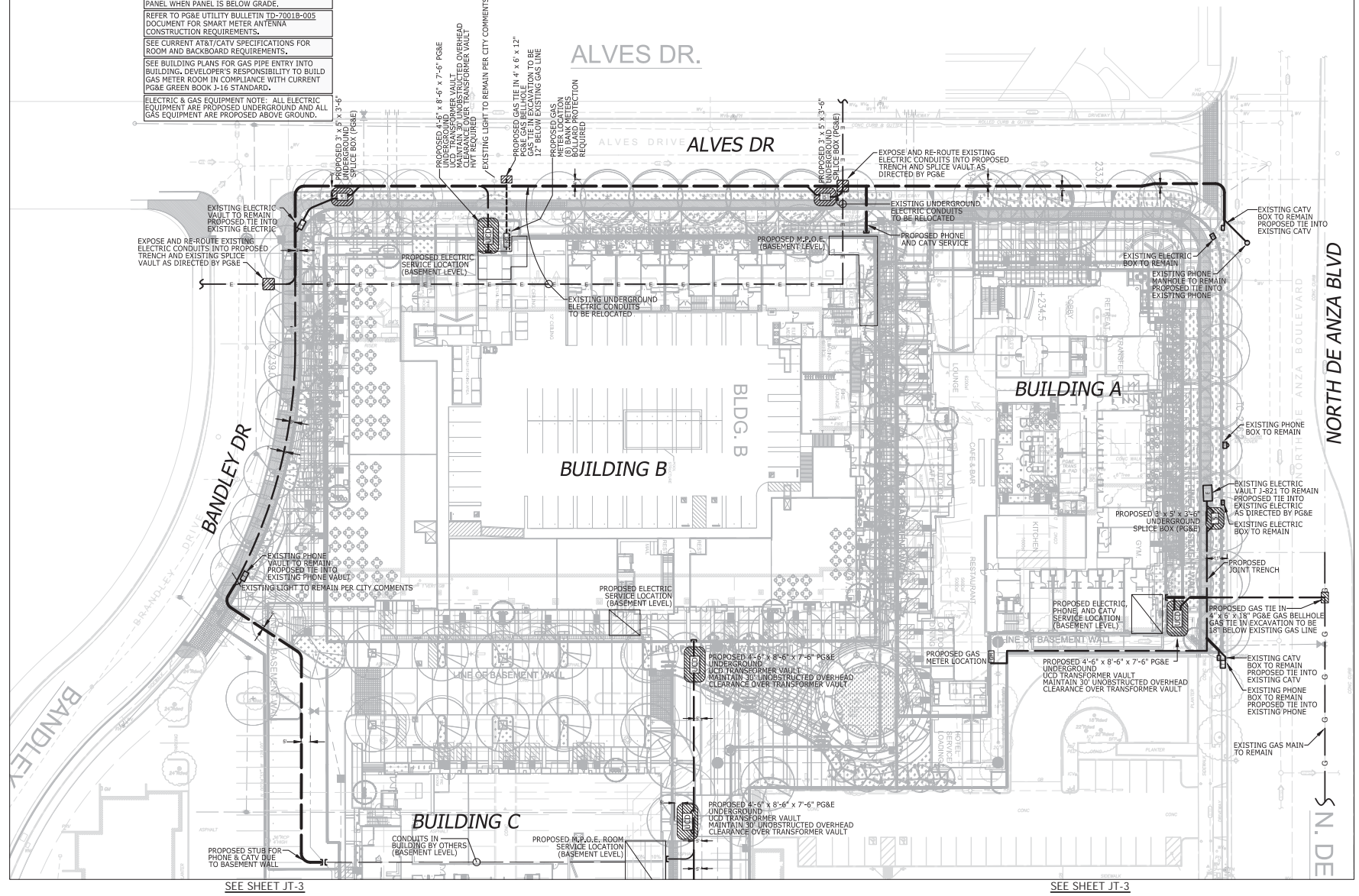

LEGEND:

- PROPOSED JOINT TRENCH
- PROPOSED 4'-6" x 8'-6" x 7'-6" UNDERGROUND UCD TRANSFORMER (PG&E) WORKING SPACE SHOWN MAINTAIN 30' UNOBSTRUCTED OVERHEAD CLEARANCE OVER TRANSFORMER VAULT
- PROPOSED 3' x 5' x 3'-6" UNDERGROUND SPLICE BOX (PG&E) WORKING SPACE SHOWN
- PROPOSED 4' x 6' x 18" GAS BELLHOLE (PG&E)
- PROPOSED GAS METER LOCATION
- EXISTING GAS MAIN
- EXISTING ELECTRIC VAULT/BOX TO REMAIN
- EXISTING PHONE BOX TO REMAIN
- EXISTING CATV BOX TO REMAIN
- EXISTING UTILITY VAULT TO REMAIN

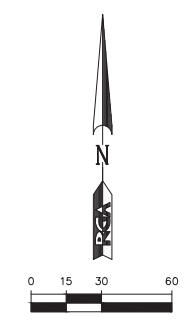
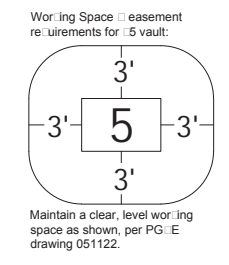
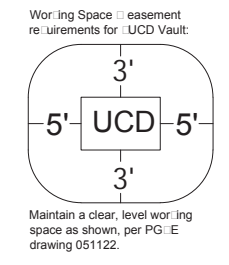

SHEET INDEX

JT-1	JOINT TRENCH TITLE SHEET
JT-2,3	JOINT TRENCH INTENT



MARINA PLAZA

10145 DE ANZA BLVD. AND 10122 BANDLEY DR. CUPERTINO, CALIFORNIA
De Anza Venture, LLC

JOB NO. 1250.001
DATE 04-21-16



5865 Owens Drive
Pleasanton, CA 94588
925-251-7200

JT-2

SEE SHEET JT-2

SEE SHEET JT-2

SEE BUILDING PLANS FOR CONDUIT ENTRY INTO BUILDING. DEVELOPER'S RESPONSIBILITY TO BUILD ELECTRIC METER ROOM IN COMPLIANCE WITH CURRENT PG&E GREEN BOOK SECTION 10 STANDARD. DO NOT BOTTOM FEED ELECTRIC CONDUITS INTO PANEL WHEN PANEL IS BELOW GRADE.

REFER TO PG&E UTILITY BULLETIN TD-7001B-005 DOCUMENT FOR SMART METER ANTENNA CONSTRUCTION REQUIREMENTS.

SEE CURRENT AT&T/CATV SPECIFICATIONS FOR ROOM AND BACKBOARD REQUIREMENTS.

ELECTRIC & GAS EQUIPMENT NOTE: ALL ELECTRIC EQUIPMENT ARE PROPOSED UNDERGROUND AND ALL GAS EQUIPMENT ARE PROPOSED ABOVE GROUND.

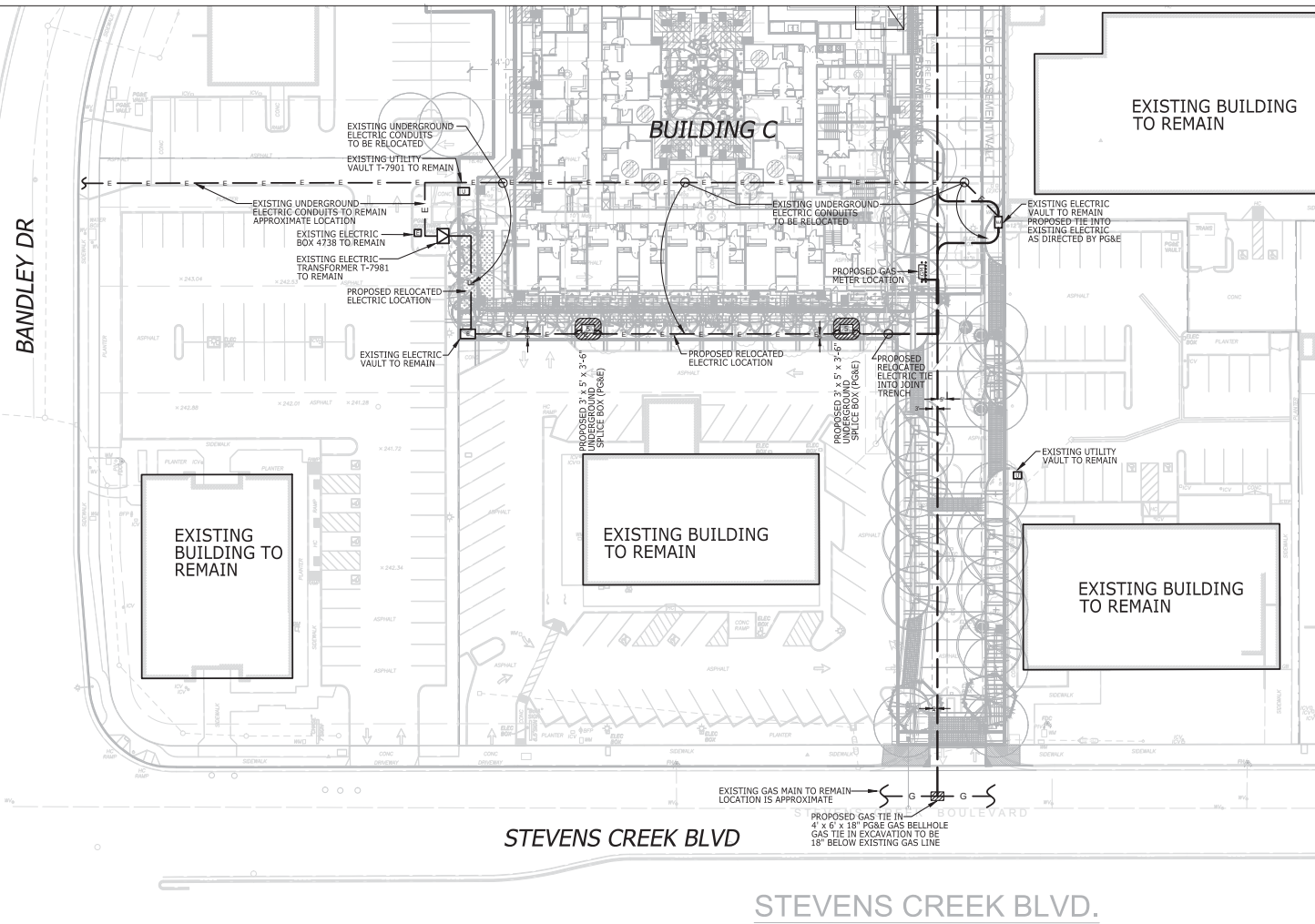

LEGEND:

- PROPOSED JOINT TRENCH
- PROPOSED 4'-6" x 8'-6" x 7'-6" UNDERGROUND UCD TRANSFORMER (PG&E) WORKING SPACE SHOWN MAINTAIN 30' UNOBSTRUCTED OVERHEAD CLEARANCE OVER TRANSFORMER VAULT
- PROPOSED 3' x 5' x 3'-6" UNDERGROUND SPLICE BOX (PG&E) WORKING SPACE SHOWN
- PROPOSED 4' x 6' x 18" GAS BELLHOLE (PG&E)
- PROPOSED GAS METER LOCATION
- EXISTING GAS MAIN
- EXISTING ELECTRIC VAULT/BOX TO REMAIN
- EXISTING PHONE BOX TO REMAIN
- EXISTING CATV BOX TO REMAIN
- EXISTING UTILITY VAULT TO REMAIN

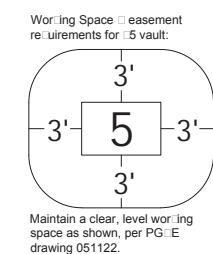
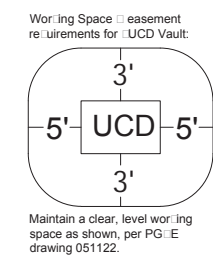

SUBSTRUCTURE LOCATIONS MUST BE STAKED BY A LICENSED SURVEYOR PRIOR TO CONSTRUCTION

NOTE TO COMCAST:
PLEASE CONFIRM WHO WILL PROVIDE CONDUIT AND VAULTS. DEVELOPER TO PROVIDE TRENCH.

NOTE FOR UNDERGROUND ELECTRIC INSTALLATION:
USE OF STANDARD PVC DB-120 IS NO LONGER APPROVED BY PG&E FOR 2" CONDUIT SIZE AND BENDS. PVC DB-120 CELLULAR CORE CONDUIT CAN BE USED IN PLACE OF STANDARD PVC DB-120 CONDUIT. FOR ALL APPROVED 2" CONDUITS AND BENDS, SEE BULLETIN TD-062288B-001.

UTILITIES
PLEASE CONFIRM TIE IN LOCATIONS

-PRELIMINARY-
NOT FOR CONSTRUCTION

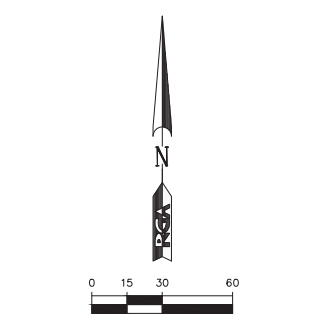

SHEET INDEX

JT-1	JOINT TRENCH TITLE SHEET
JT-2,3	JOINT TRENCH INTENT

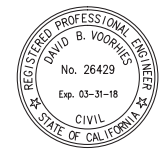

MARINA PLAZA

10145 DE ANZA BLVD. AND 10122 BANDLEY DR. CUPERTINO, CALIFORNIA
De Anza Venture, LLC

JOB NO. 1250.001
DATE 04-21-16



5865 Owens Drive
Pleasanton, CA 94588
925-251-7200

JT-3