

Community Meeting #2



THE LOOP
Cupertino

Junipero Serra Trail

February 20 and 26, 2018

Welcome!

How to get started

- Travel to each of the stations and provide your input
- Enjoy the refreshments
- Ask us lots of questions

I. General Background

1. Did you attend Community Meeting #1?

Circle one.

- A.** Yes
- B.** No

2. Do you support a trail at this location?

Circle one.

- A.** Yes
- B.** No

3. How would you use the trail?

Circle all that apply.

- A.** Biking
- B.** Jogging
- C.** Walking
- D.** Commuting
- E.** Other:

4. Do you live or work in Cupertino?

Circle one.

- A.** I live in Cupertino
- B.** I work in Cupertino
- C.** I live and work in Cupertino
- D.** I do not live or work in Cupertino

II. Trail Design

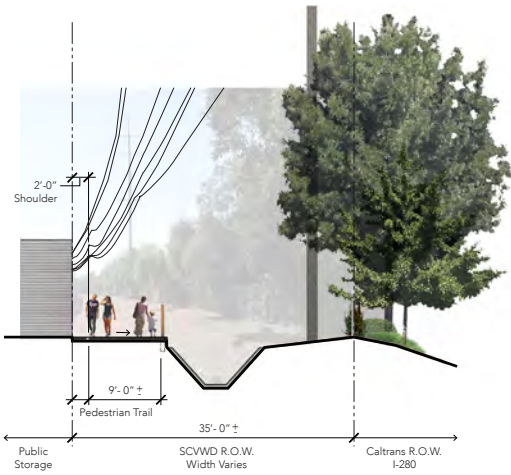

Alternative #1
Open Drainage Ditch, Pedestrian Trail

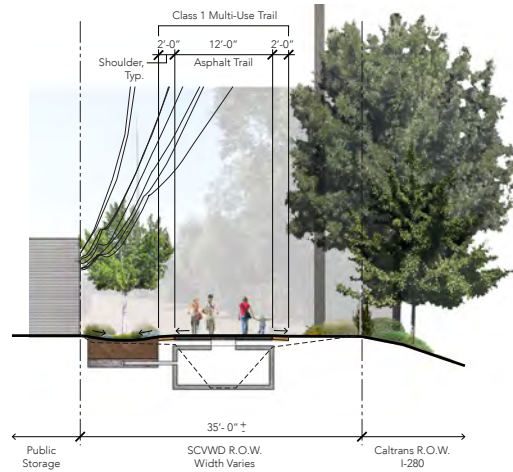

Alternative #2
Covered Drainage Ditch, Class 1 Multi-Use Trail

1. Which alternative do you prefer?
Circle one.

- A. Alternative #1
- B. Alternative #2
- C. Neither

3. Do you live next to the trail?
Circle one.

- A. Yes
- B. No

2. What factors impact your decision in selecting a trail alternative?
Please provide your response below.

4. Do you have children that would use this trail?
Circle one.

- A. Yes
- B. No
- C. Possibly in the future

STATION #3 - Mary Avenue Trail Access

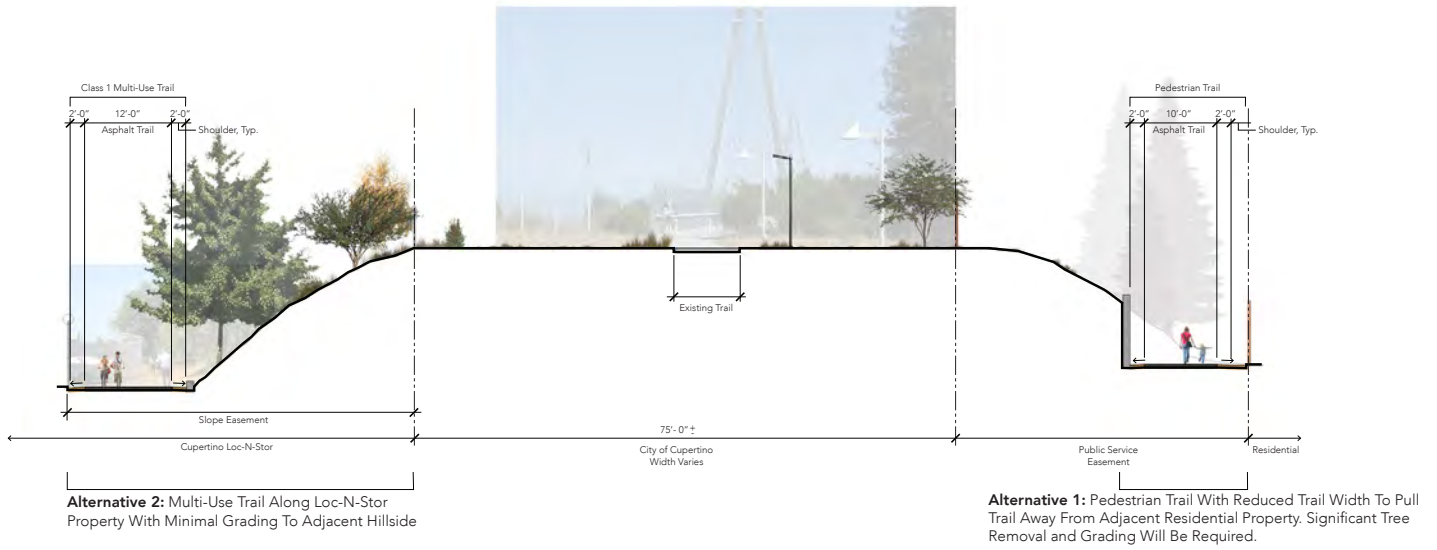

Alternative #2 Class 1 Multi-Use Trail

Alternative #1 Pedestrian Trail

III. Mary Avenue

1. Which alternative do you prefer?
Circle one.

- A. Alternative #1
- B. Alternative #2
- C. Neither

3. Would you use Mary Avenue Bridge to connect to this trail system?
Circle one.

- A. Yes
- B. No
- C. Maybe

2. What factors impact your decision in selecting a trail alternative?
Please provide your response below

4. Do you have any additional comments about the Mary Avenue Trail access point?

STATION #3 - Stelling Road

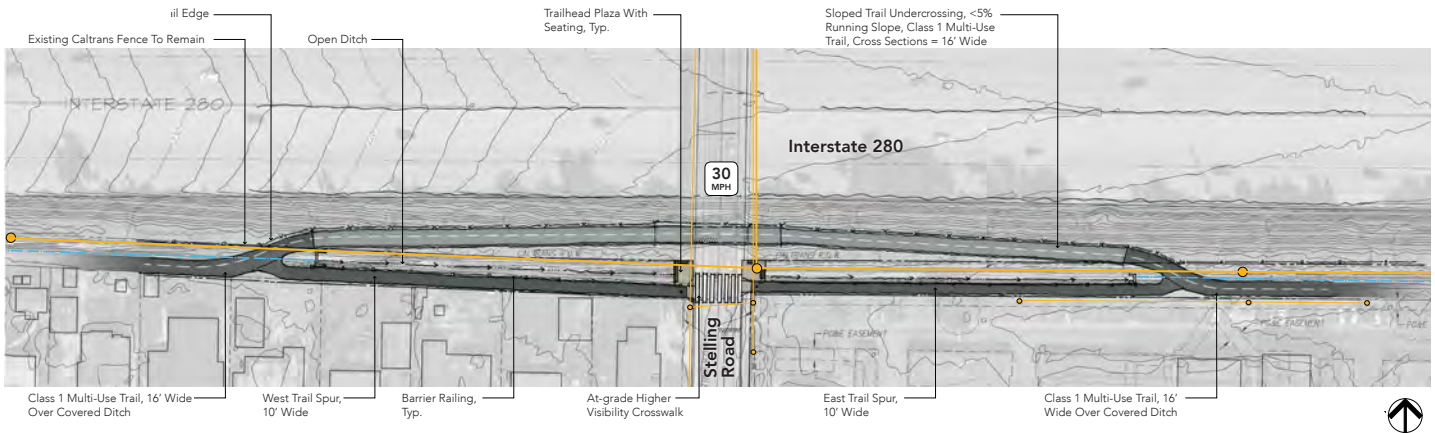

Stelling Road Crossing Options

IV. Stelling Road Crossing

1. What crossing type do you prefer? Circle one.

- A. A grade-separated crossing under Stelling Road with spur trail access and no crosswalk across Stelling Road
- B. A crosswalk across Stelling Road with no grade-separated crossing under Stelling Road or spur trail access
- C. Both a grade-separated crossing and crosswalk across Stelling Road with spur trail access

Do you have any additional comments about the Station #3 trail segment?

STATION #4 - De Anza Boulevard

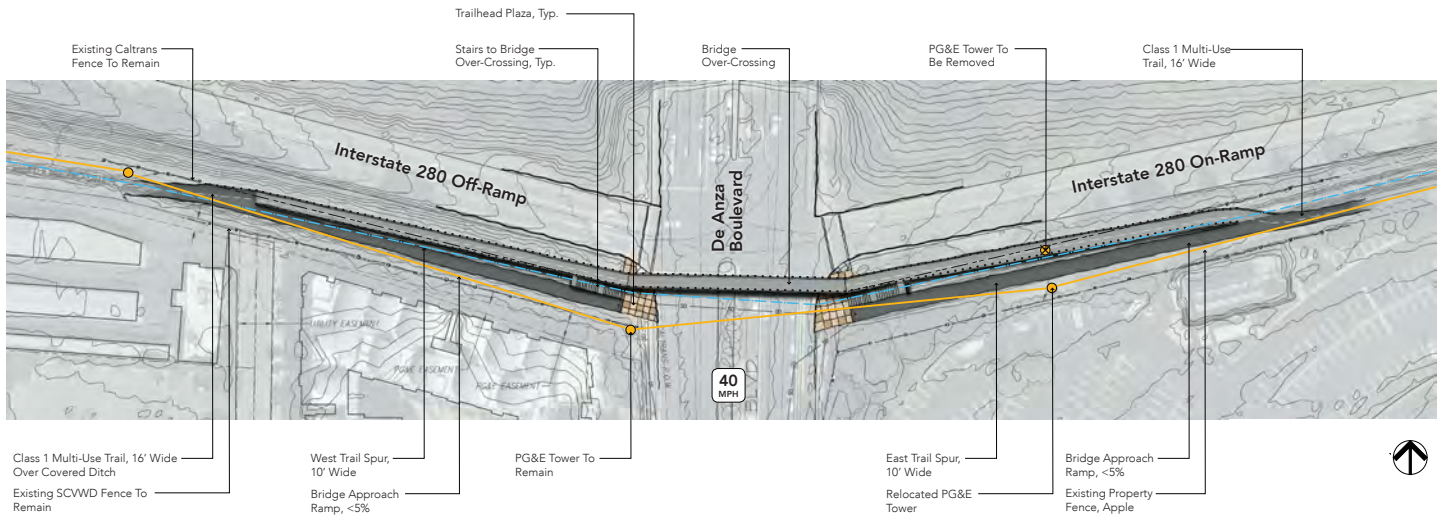

De Anza Boulevard Bridge Over-Crossing

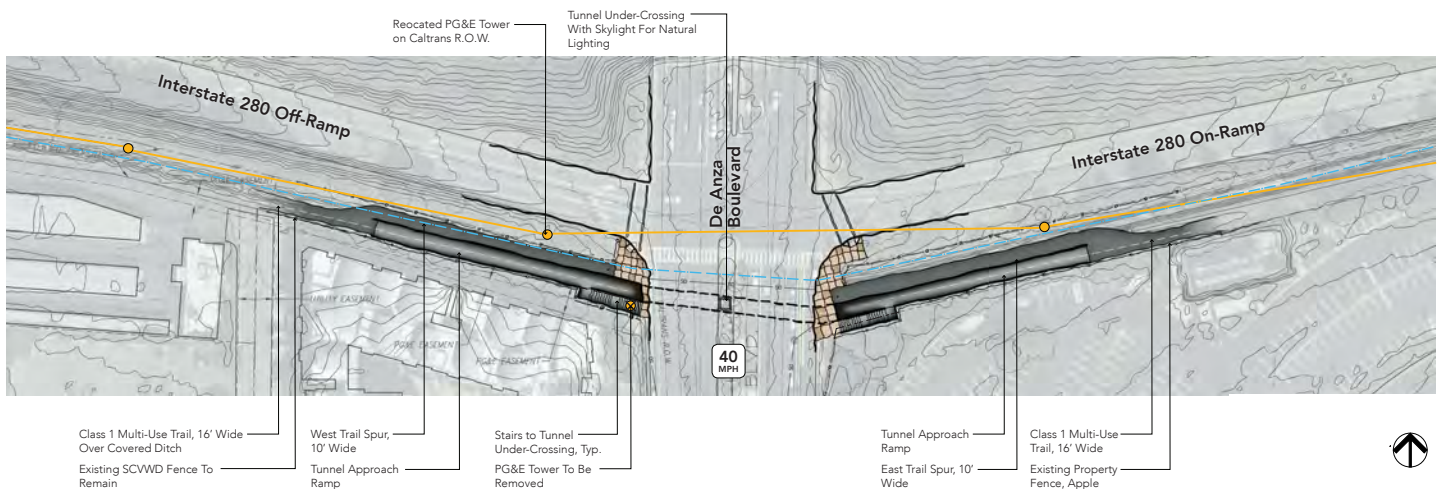

De Anza Boulevard Tunnel Under-Crossing

V. De Anza Boulevard Crossing

1. What crossing type do you prefer?

Circle one.

- A. Bridge over-crossing with crosswalk across De Anza Boulevard
- B. Tunnel under-crossing with crosswalk across De Anza Boulevard
- C. No grade-separated crossing and maintain existing crosswalk across De Anza Boulevard

2. Would you support removal of the existing crosswalk across De Anza Boulevard if the bridge or tunnel grade-separated crossing was provided?

Circle one.

- A. Yes
- B. No
- C. Maybe

STATION #4 - Blaney Road

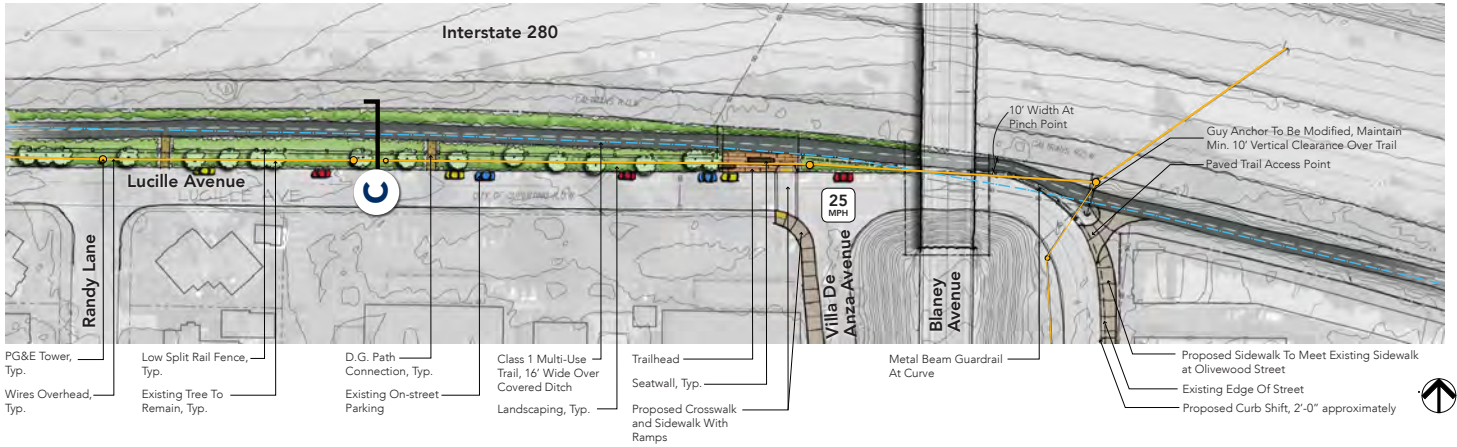

Blaney Avenue with Trail Access on Lucille Avenue

VI. Blaney Avenue / Lucille Avenue

1. Regarding trail access and amenities, which of the following do you support? Circle one.

- A. Informal trail access and no trailhead or trail amenities at this location
- B. Single trail access point and trailhead with limited trail amenities at this location
- C. Multiple trail access points and a trailhead with greater level of amenities at this location

Do you have any comments about the Station #4 trail segment?



STATION #5 - Vallco Center to Vallco Parkway

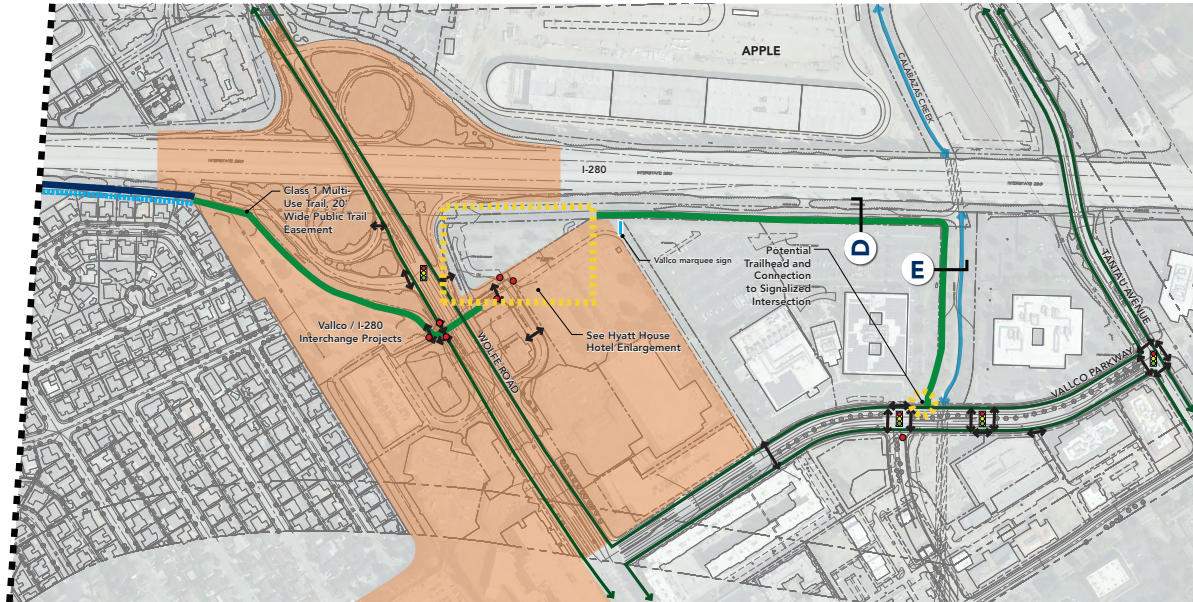

VII. Vallco Center to Vallco Parkway

Do you have any comments about the Station #5 trail segment?

Please return your packet to the sign-in table

Do you have any other comments about the project?

Thank you for your participation! Please join us again for:

Community Meeting #3

Wednesday, June 6, 2018

6:00pm – 8:00pm

Cupertino Community Hall

10350 Torre Ave, Cupertino, CA 95014